

部分尺寸(AA) some sizes(AA)

	刃徑 φD Diameter	3.0	4.0	4.5
	刃徑 φD1 Diameter	3.67	5.07	5.07
	柄徑 φd Shank Dia.	2.35	2.35	2.35
	總長L Overall Length 總長さ	27.5	27.5	27.5

材料:

- ① 超高防锈高耐磨高硬度不銹鋼系列(AA)(HRC54° ± 2° 斷面)(常規常備)
- ② 常規標準防锈高耐磨不銹鋼系列(A)(HRC45° ~ 64° 斷面系列)

Material:

Ultra high rust-proof, high wear-resistant & high-hardness stainless steel series (AA)(HRC54° ± 2° Section)(regular stock)
 ② General anti-rust high wear resistance stainless steel series(A)(HRC45° ~ 64° Section series)

可超高锋利型 & 一般锋利型
 ultra-high sharp & general sharp

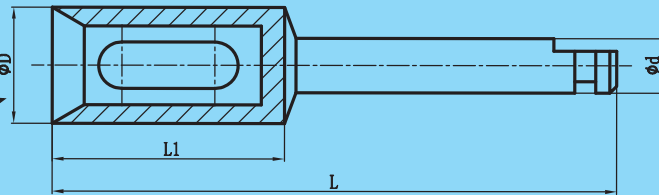

部分尺寸(AA) some sizes(AA)

	刃徑 φD Diameter	3.0	4.0	5.0	6.0
	刃長L1 length of cut 刃の長さ	11.3	11.3	11.3	11.3
	柄徑 φd Shank Dia.	2.35	2.35	2.35	2.35
	總長L Overall Length 總長さ	31	31	31	31

φD均為外徑尺寸, 內孔比外徑小1mm; 總長可以按貴司要求生產, 壁厚常規見0.5mm, 也可以0.25; 0.3mm, 可以根據貴司需要生產。All the φD are out diameters. The inner holes are 1mm smaller than out diameters. The total length can be produced according to your esteemed's requirement. The normal wall thickness is 0.5mm. 0.25mm, 0.3mm, or sizes as per your requirement are all OK.